



CHATTERTON | REES



17a Ashburnham Road, London, SW10 0PG
Asking price £525,000





17a Ashburnham Road

London, SW10 0PG

- Bedroom
- Reception Room
- Garden
- Bathroom
- Kitchen
- EPC Rating C

A sensible lower ground floor, one bedroom flat with a private south facing garden approached via the kitchen. The flat has made an excellent home and then rental investment for our client and has a generous reception room and a good sized bedroom with a bathroom. It also has a lapsed planning permission to go into the garden and make the property a 2 bedroom.

Ashburnham Road is in the heart of Lots Village Conservation Area and is well situated to benefit from the exciting new Chelsea Waterfront Development. The Kings Road is nearby with a wonderful array of shops, bars and restaurants. Excellent transport links can be found nearby including multiple bus routes as well as Imperial Wharf Rail Station and Fulham Broadway (District Line). Westfield Park is moments away and offers an area for dogs and a children's playground.

Asking price £525,000





Directions





Floor Plans

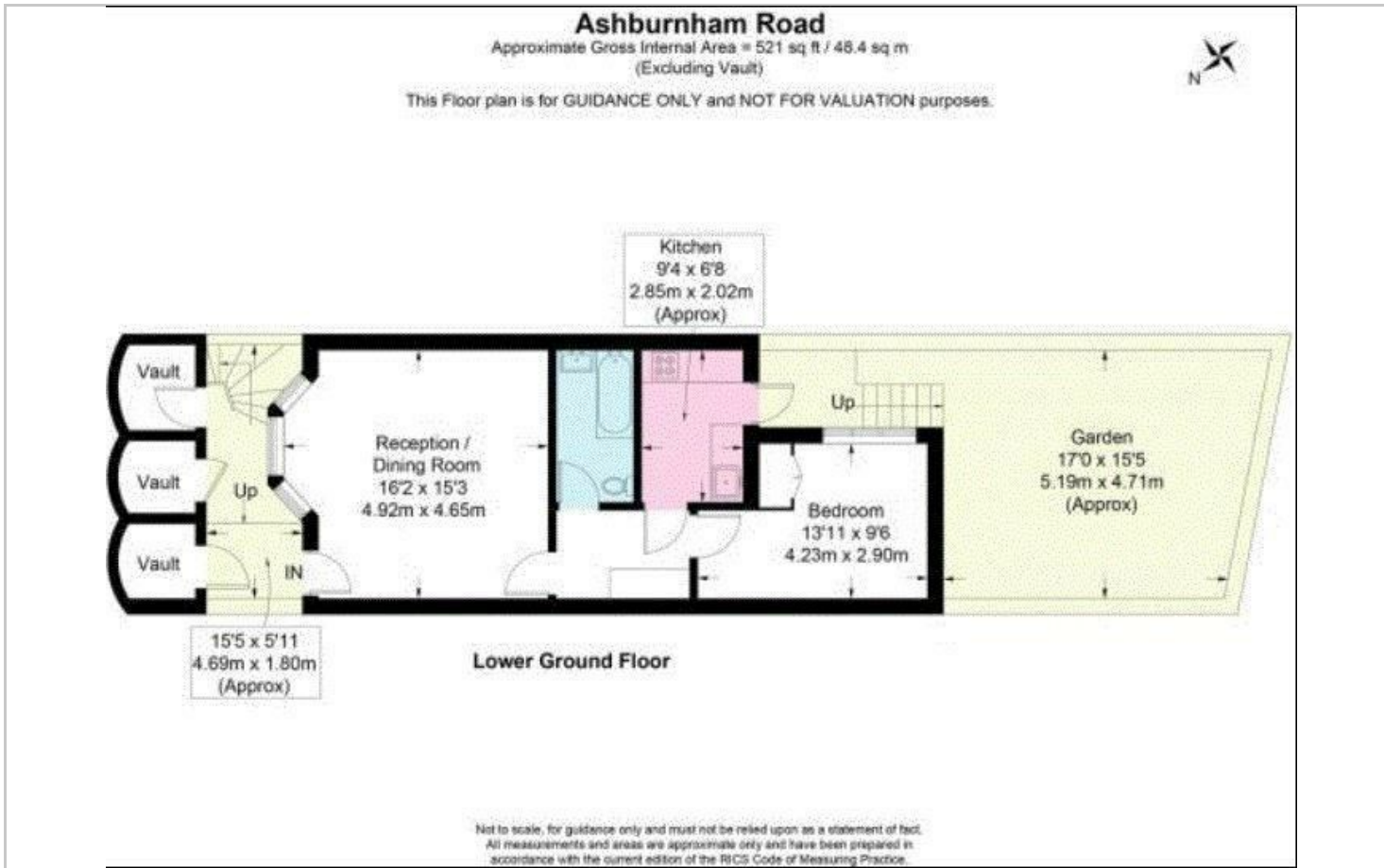

Location Map

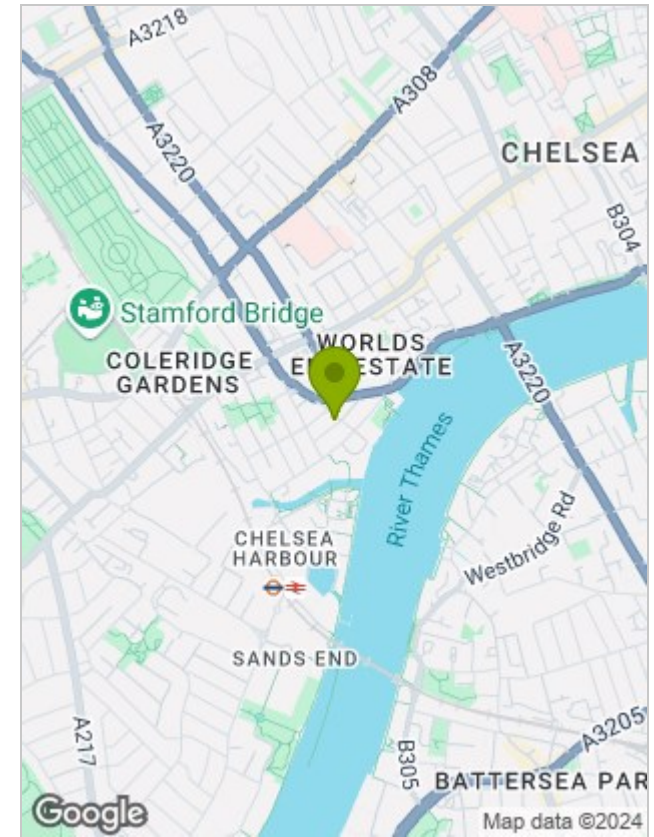

Energy Performance Graph

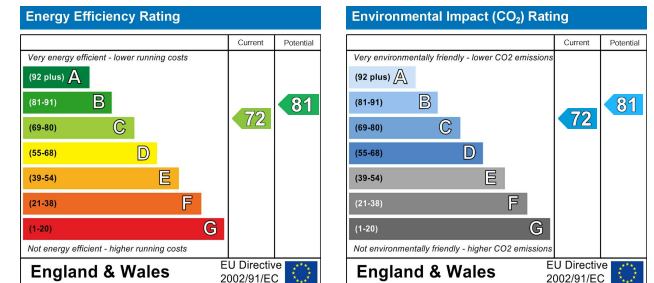

Viewing

Please contact our Chatterton Rees Office on 020 3780 0580 if you wish to arrange a viewing appointment for this property or require further information.

The particulars are set out as a general outline only for the guidance of intended purchasers or lessees, and do not constitute, any part of a contract. Nothing in these particulars shall be deemed to be a statement that the property is in good structural condition or otherwise nor that any of the services, appliances, equipment or facilities are in good working order. Purchasers should satisfy themselves of this prior to purchasing.